

1-COMplete FRAME ASSEMBLY

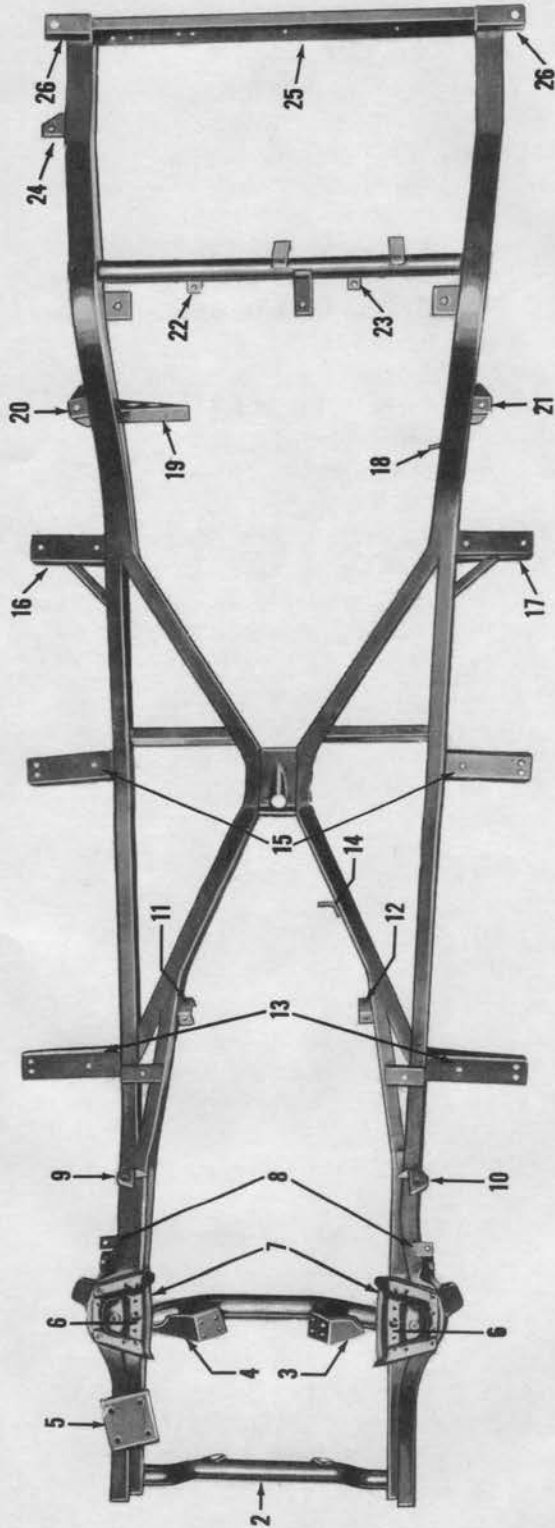

FRAME ASSEMBLY
ILLUSTRATION NO. 1

ILLUS. KEY	PART NO.	DESCRIPTION	ALL	1	2	3	4	5
		<u>FRAME ASSEMBLY</u>						
			MODELS	A 11	A 12 W	A 12	A 11 E	A 12 E
1-1	701014	FRAME ASSY. - Chassis Complete	1					
1-2	701011	CROSSMEMBER ASSY. - Frt.	1					
1-3	702046	BRACKET - Front Engine Mtg. R.H.	1					
1-4	702045	BRACKET - Front Engine Mtg. L.H.	1					
1-5	701105	BRACKET ASSY. - Battery Support	1					
1-6	94525 142783	BRACKET - Upper Control Arm to Frame R.+ L.H. RIVET - Upper Control Arm to Frame (5/16" x 3/4" Rd. Hd.)	2 12					
1-7	92243 117557 141471	SEAT - Front Spring RIVET - Front Spring Seat to Frame (5/16" x 3/4" Fl. Hd.) RIVET - Front Spring Seat to Frame (5/16" x 1" Fl. Hd.)	2 4 4					
1-8	92639	BRACKET - Front Brake Hose	2					
1-9	94306	BRACKET - Dash Supt. R.H.	1					
1-10	94305	BRACKET - Dash Supt. L.H.	1					
1-11	702058	BRACKET - Rear Engine Supt. R.H.	1					
1-12	702057	BRACKET - Rear Engine Supt. L.H.	1					
1-13	702010	BRACKET - Body Frame Front	2					
1-14	94780	BRACKET - Parking Brake Cable	1					
1-15	702011	BRACKET - Body Frame Center	2					
1-16	95638	BRACKET ASSY. - Body Frame Rear R.H.	1					
1-17	95637 96103 181637 96101	BRACKET ASSY. - Body Frame Rear L.H. BRACKET - Frame Rear Spring Frt. BOLT - Frame Rear Spring Frt. Brkt. Mtg. (3/8"-24 x 1" Hex. Hd.) NUT - Frame Rear Spring Frt. Brkt. Mtg. (3/8"-24 Hex.)	1 2 8 8					
1-18	92502	BRACKET - Rear Brake Hose	1					
1-19	94296	SUPPORT - Muffler	1					
1-20	702024	BRACKET - Axle Inhibitor Frame R.H.	1					
1-21	702023	BRACKET - Axle Inhibitor Frame L.H.	1					
1-22	93866	BRACKET ASSY. - Shock Absorber Mtg. R.H.	1					
1-23	93865	BRACKET ASSY. - Shock Absorber Mtg. L.H.	1					
1-24	94675	SUPPORT - Muffler Outlet	1					
1-25	93870	CROSSMEMBER ASSY. - Rear	1					
1-26	94520	BRACKET - Frame Rear Corner to Body	2					
		<u>FRONT AND REAR BUMPER</u>						
2-1	92592	GUARD ASSY. - Frt. R.H. & Rear L.H.		2	1	2	2	2
2-2	92593	GUARD ASSY. - Frt. L.H. & Rear R.H.		2	1	2	2	2
2-3	180122	BOLT - Front & Rear Bumper Bar & Guard to Supt. Brkt. (3/8"-16 x 1" Hex. Hd.)	8					
2-4	178566	LOCKWASHER - Frt. & Rear Bumper Bar & Guard to Supt. Brkt. (3/8 Int. Ext.)	4					
2-5	120382	LOCKWASHER - Frt. & Rear Bumper Bar Guard to Supt. Brkt. (3/8")	4					

ILLUS. KEY	PART NO.	DESCRIPTION	ALL	1	2	3	4	5
			M O D E L S	A 11	A 12 W	A 12	A 11 E	A 12 E
<u>FRONT AND REAR BUMPER (Cont'd)</u>								
2-6	120377	NUT-Frt. & Rear Bumper Bar & Guard to Supt. Brkt. (3/8"-16 Hex.)	8					
2-7	94752	BAR - Frt. & Rear Bumper Face	2					
2-8	121807	BOLT-Frt. & Rear Bumper Bar to Supt. Brkt. Upper-Chrome (3/8"-16 x 1 Rd. Hd.)	4					
2-8A	126227	BOLT-Frt. & Rear Bumper Bar to Supt. Brkt. Lower-Chrome (3/8"-16 x 3/4 Rd. Hd.)	4					
2-9	102382	LOCKWASHER-Frt. & Rear Bar to Brkt. (3/8")	8					
2-10	120377	NUT-Frt. & Rear Bumper Bar to Supt. Brkt. (3/8"-16 Hex.)	8					
2-11	98303	BRACKET-Frt. & Rear Bumper Bar Supt.	8					
2-12	120917	BOLT-Frt. & Rear Bumper Supt. Brkt. to Bumper Supt. (1/2"013 x 1-12" Rd. Hd.)	8					
	120396	PLAINWASHER-Frt. & Rear Bumper Supt. Brkt. to Bumper Supt. (17/32 I.D. x 1-1/16 O.D. O.D.)	8					
2-13	186425	LOCKWASHER-Frt. & Rear Bumper Supt. Brkt. to Bumper Supt. (1/2")	8					
2-14	120378	NUT-Frt. & Rear Bumper Supt. Brkt. to Bumper Supt. (1/2" - 13 Hex.)	8					
2-15	702243	SUPPORT-Frt. Bumper to Frame	2					
2-16	181698	BOLT-Frt. Bumper Supt. to Frame (1/2"-20 x 1-1/4" Hex. Hd.)	2					
2-17	120396	PLAINWASHER-Frt. Bumper Supt. to Frame (17/32 I.D. x 101/16" O.D.)	4					
2-18	186425	LOCKWASHER-Frt. Bumper Supt. to Frame (1/2")	4					
2-19	120371	NUT-Frt. Bumper Supt. to Frame (1/2"-20 Hex.)	4					
2-19A	191695	BOLT-Front Bumper Support to Frame	2					
2-20	702277	SUPPORT-Rear Bumper to Frame	2					
2-21	181698	BOLT-Rear Bumper Supt. to Frame Rear (1/2"-20 x 1-1/4" Hex. Hd.)	4					
2-22	120396	PLAINWASHER-Rear Bumper Supt. to Frame Rear (17/32" I.D. x 1-1/16" O.D.)	4					
2-23	186425	LOCKWASHER-Rear Bumper Supt. to Frame (1/2")	4					
2-24	189347	BOLT-Rear Bumper Supt. to Frame Side (1/2" - 20 x 1-1/8 Hex. Hd.)	2					
2-25	120396	PLAINWASHER-Rear Bumper Supt. to Frame Side (17/32" I.D. x 1-1/16" O.D.)	2					
2-26	186425	LOCKWASHER-Rear Bumper Supt. to Frame Side (1/2")	2					
2-27	120371	NUT - Rear Bumper Supt. to Frame Side (1/2" - 20 Hex.)	2					
2-28	95320	LAMP ASSY. - License Bumper Mounted	1					
2-28	02220	LENS ASSY. - License Lamp	1					
2-29	142450	BULB-Licence Lamp Mtg.	1					
2-30	02221	GASKET-License Lamp Mtg.	1					
	02223	WASHER - License Lamp Cable	1					
2-31	02224	SPRING-License Lamp Cable	1					
2-32	02225	SOCKET & TUBE ASSY. - License Lamp	1					

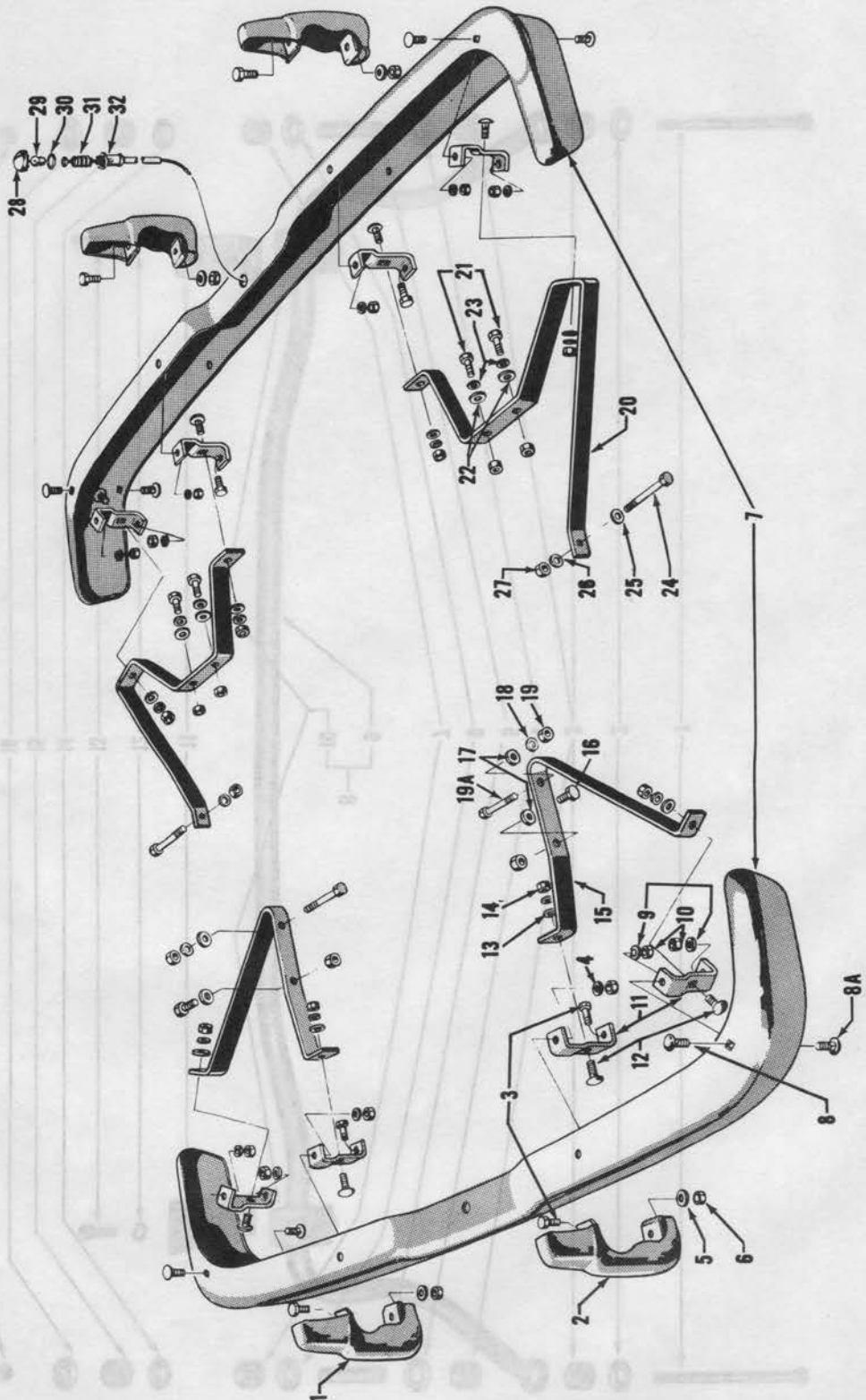

FRONT AND REAR BUMPER ASSEMBLY

ILLUSTRATION NO. 2

ILLUSTRATION NO. 2