

# SUSPENSION-REAR

ILLUS. KEY	PART NO.	DESCRIPTION	ALL MODELS	GROUP 3							
				1	2	3	4	5	6	7	
				A 11	A 11 E	A 12	A 12 E	A 12 W	A 12 W 6	A 12 W 8	
<b>REAR SPRING AND SHOCK ABSORBER</b>											
5A-1	98300	PLATE—Rear Spring Lower		2	2	2	2	2			
	702603	PLATE—Rear Spring Lower									2
5A-2	98301	BRACKET—Rear Shock Absorber Lower L.H.	1								
5A-3	98302	BRACKET—Rear Shock Absorber Lower R.H.	1								
5A-4	65198	NUT—Rear Spring to Rear Axle Clip	8								
5A-5	271758	BOLT—Rear Spring Front to Frame Brkt. (5/8—18 x 4-1/2 Hex. Hd.)	2								
5A-6	121574	LOCKWASHER—Rr. Spr. Frt. to Frame Brkt. (5/8)	2								
5A-7	121358	NUT—Rr. Spr. Frt. to Frame (5/8—18 Hex.)	2								
5A-8	95634	PLATE AND PIN ASM.—Rear Shackle	2								
5A-9	96153	BUSHING—Rear Shackle Plate	8								
5A-10	80768	PLATE—Rear Shackle	2								
5A-11	626852	LOCKNUT—Rear Shackle Plate and Pin (1/2—20 Hex.)	4								
5A-12	703942	SHOCK ABSORBER ASM.—Rear		2	2	2	2	2			
5A-13	703944	SHOCK ABSORBER ASM.—Rear (Heavy Duty)		2	2	2	2	2			
	703946	SHOCK ABSORBER ASM.—Rear									2
5A-14	706089	INSULATOR—Shock Absorber Mtg.	8								
5A-15	94408	WASHER—Shock Absorber Mtg. Outer	4								
5A-16	706090	RETAINER—Shock Absorber Inner—Upper Mtg. Only	2								
	706092	RETAINER—Shock Absorber Inner—Lower Mtg. Only	2								
5A-17	442828	NUT—Shock Absorber Mtg. (3/8—24)	8								
5A-18	701015	BUMPER ASM.—Rear Spring Frame		2		2		2			
	95651	BUMPER ASM.—Rear Spring Frame									2
5A-19	92289	BUMPER ASM.—Rear Spring Frame			2		2				
	702354	CLIP—Rear Spring Frame Bumper		2	2	2	2	2			
5A-20	120382	LOCKWASHER—Rear Spring Frame Bumper Mtg. (3/8 Med. Spr.)		2		2		2			
5A-21	120369	NUT—Rear Spring Frame Bumper Mtg. (3/8—24 Hex.)		2		2		2			
5A-22	446477	WASHER—Rear Spring Frame Bumper Spacer (7/16 ID x 1—3/8 OD)		30	30	30	30	30			
5A-23	702356	BUMPER—Rear Axle		2	2	2	2	2			
5A-24	702354	CLIP—Rear Axle Bumper Mtg.		2	2	2	2	2			
5A-25	448665	SCREW—Rr. Axle Bumper to Frame (5/16—18 x 3/4 Hex.)	4								
5A-26	97039	SPRING ASM.—Rear		2	2	2	2				
	701444	SPRING ASM.—Rear						2			
	04566	BOLT and NUT ASM.—Spr. Ctr. (5/16—24 x 2 Hex.)		2	2	2	2	2			

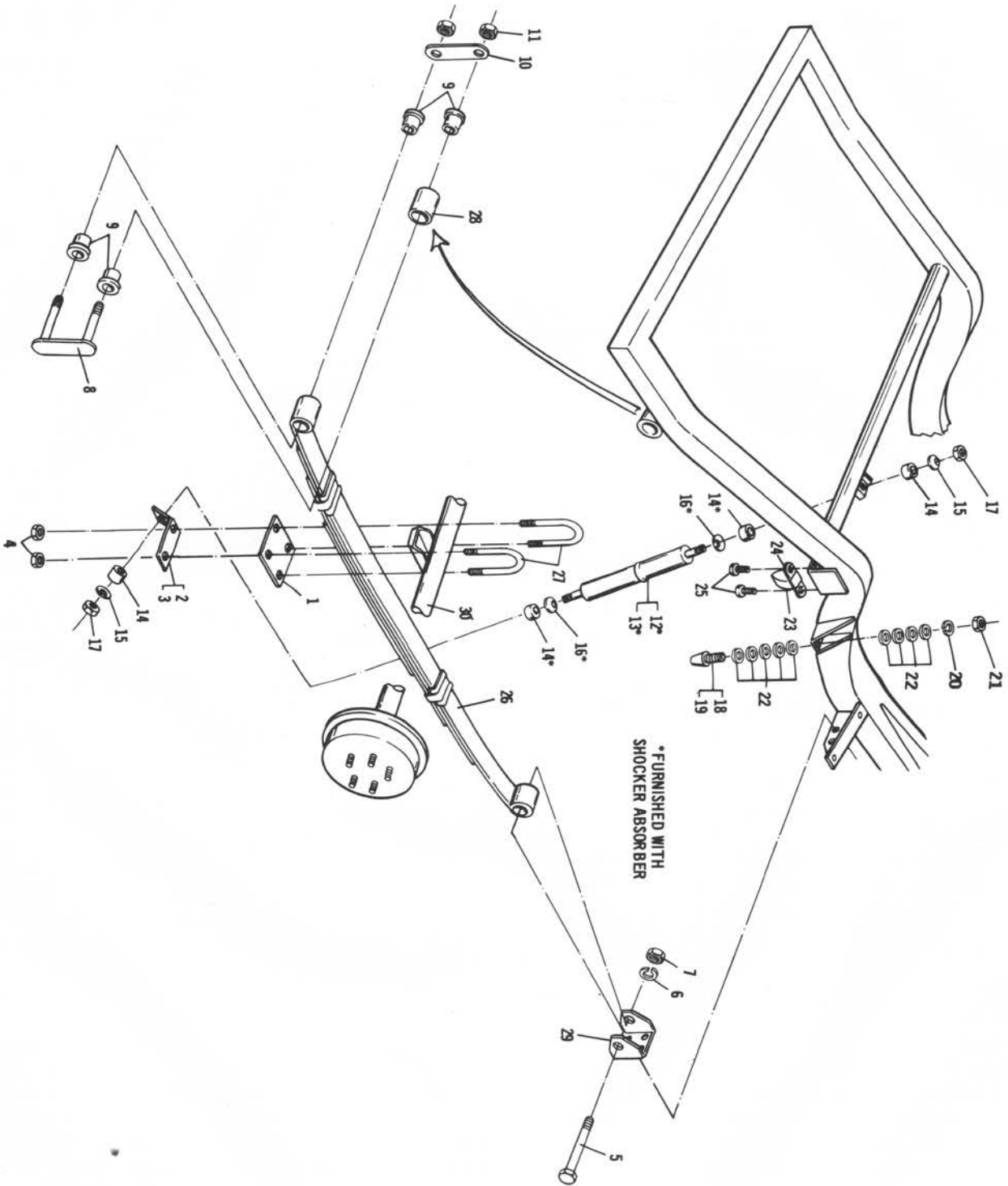

REAR SPRING AND SHOCK ABSORBER  
ILLUSTRATION NO. 5A



