

**INTERIOR****SECTION I. TRIM PANELS****1-1. Roof Trim.**

- a. Pry the roof trim moulding strips loose and remove from the vehicle.
- b. Flex the front and rear trim panels down at the center and pull loose from the end and side retainer clips.

**1-2. Driver's Compartment Trim.**

- a. Remove twelve sheet metal screws and washers directly below the windshield to remove the defroster deflector retainer, deflector and gasket.
- b. Pry the cowl side trim panels loose.

**1-3. Passenger and Cargo Compartment Trim.****a. Sedans.**

(1) To remove the rear shelf trim panel, remove the rear seat back and pry the panel assembly and retainer clips loose.

(2) To remove the quarter trim panels, remove arm rests and eight screw and lockwasher assemblies at each panel or pry out panels with snap clips.

**b. Station wagons.**

(1) To remove the vertical bumper mouldings, jack up the rear of the vehicle and remove the nuts from the studs at each moulding, working inside the rear fender.

(2) To remove the horizontal bumper mouldings, pry the mouldings and clips from the vehicle, using a screwdriver.

(3) Remove screws to remove each wheelhouse access panel.

**SECTION II. GLOVE COMPARTMENT****2-1. All A-12 Model Cars.**

a. Remove the glove box stop from each side of the glove compartment. If necessary, remove the front ash trays to gain access to the stop screws, as follows:

(1) Depress the receptacle clip and remove the ash tray receptacle.

(2) Remove three screws and remove the ash tray housing.

- b. Remove five screws to remove glove box compartment and hinge assembly.
- c. Remove the screw and lockwasher inside the glove box and remove the sleeve and lock assembly.
- d. If necessary, remove two screws and remove the lock striker from the dash.
- e. To install, reverse removal instructions.

**2-2. All A-11 Model Cars.**

a. Remove two nuts and lockwashers and remove the lock assembly.

b. If necessary, remove two screws and remove the lock striker.

c. Remove two nuts and lockwashers at each side of the underside of the glove compartment.

d. Remove two nuts and lockwashers at each side of the interior of the glove compartment door. Remove the door.

e. Remove the hinges by pulling them downward.

f. Remove four mounting screws and remove the glove compartment body.

g. To install reverse removal instructions.

## SECTION III. HEATERS

## 3-1. Trouble Shooting.

a. Blower or fan fails to operate.

- (1) Check the motor ground wire for loose connection or open circuit.
- (2) Test the motor switch wire for open or short circuit.
- (3) Test the motor switch and resistor assembly for proper operation.
- (4) Check the fan or blower blades for obstructions or insufficient clearance.
- (5) Bench test the fan or blower motor.

b. Air output insufficient.

- (1) Check for obstructions in air passages.
- (2) Check the fan or blower blades for damage, insufficient clearance, or obstructions.
- (3) Check the control cables for proper operation.
- (4) Test the fan or blower wiring, switch, and motor as in Section 3-1.

c. Heat insufficient.

- (1) Check visually for leaking heater core or hoses.
  - (a) With dash heaters, look for water on the floor mat of the driver's compartment.
  - (b) With floor mounted under seat heaters, look for water under the standing vehicle at the position of the driver's seat.
- (2) Check the engine temperature gage to see if engine is warmed to proper temperature range. Replace the engine heat thermostat if necessary (see Group 9, Cooling and Heating).
- (3) Inspect the heater control valve for proper operation.
- (4) Inspect the radiator pressure cap for proper operation (see Group 9, Cooling and Heating).
- (5) Perform the checks indicated in Section 3-1b.

## 3-2. Dash Heater.

a. Test the blower motor switch and wiring, using a 12-volt test lamp.

- (1) Pull the wiring plug, located behind the instrument panel, and check the blower switch wiring harness for continuity. Replace, if necessary.
- (2) Unclip the heater blower resistor assembly and test the heater switch (1-11) for proper operation in all positions.

(3) If the heater motor (1-27) operates properly at high speed, but not at lower speeds, and if the above tests indicate that the switch and wiring harness are not defective, replace the resistor assembly.

(4) Replace the heater switch if necessary.

## (a) With all A-12 models:

- (1) Remove the heater switch/blower knob.
- (2) Remove the heater switch face plate from the heater control plate.
- (3) Disconnect the wiring harness.
- (4) Remove the rotary switch from inside the instrument panel.

## (b) With all A-11 models:

- (1) Disconnect the wiring harness.
- (2) Remove two mounting nuts and lockwashers and remove the switch assembly.

(c) To install heater switches, reverse the removal instructions.

b. Test the control cables (1-8, 9, 10) and levers (1-2) for proper operation.

- (1) Move all control levers (1-2) and check for proper operation of heater door (1-16) and defroster damper.
- (2) If controls stick or fail to operate, disconnect cables (1-8, 9, 10) and check operation manually. Replace defective cables.
- (3) If cables are not defective, check control levers for proper operation. If necessary, remove housing or panel and bracket assemblies as follows to repair or replace damaged parts:

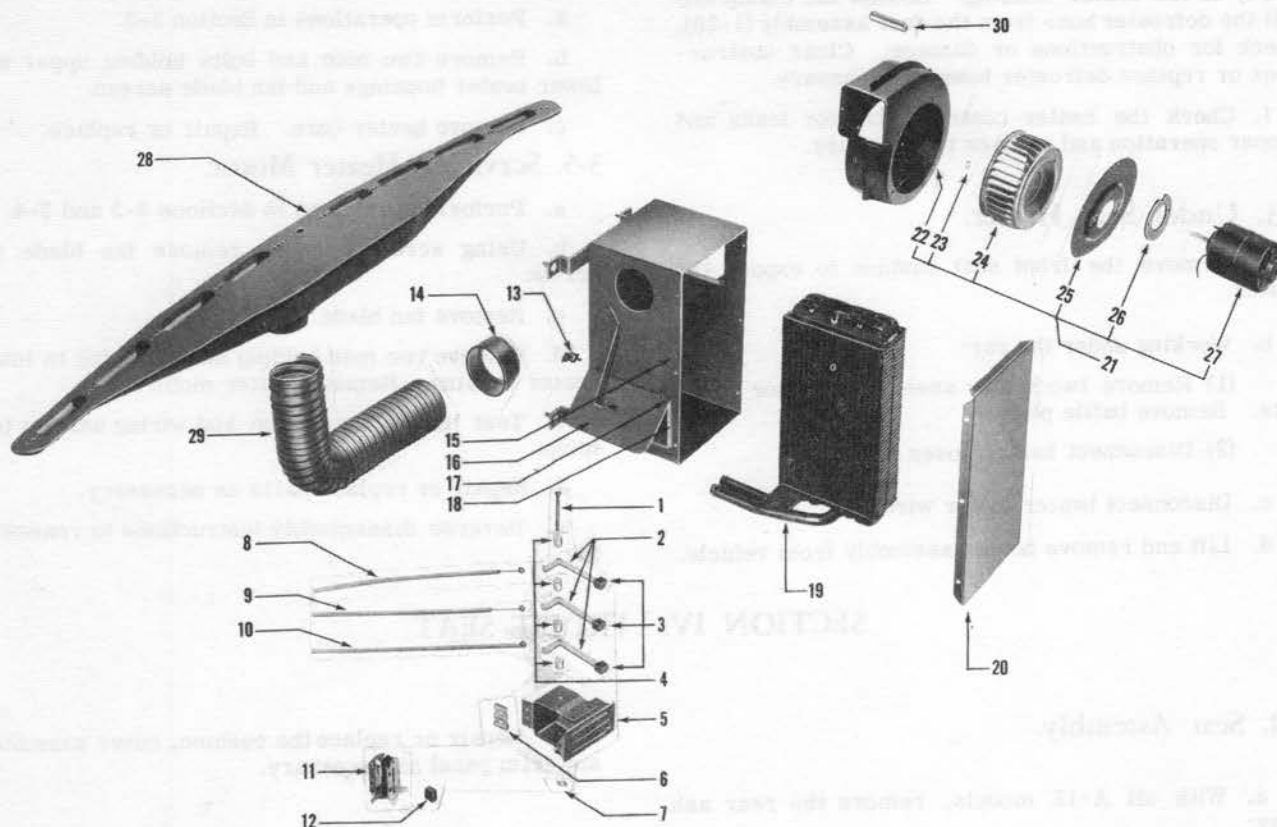

Fig. 1 - Heater and Defroster Assembly

(a) With all A-11 models, remove two screws and nuts and remove the panel and bracket assembly (1-5).

(b) With all A-12 models, perform the following operations:

(1) Follow the steps listed in Section 3-2a(4)(a) to remove the blower motor switch assembly.

(2) Remove the control lever knobs.

(3) Remove the heater control plate mounting screw and nut, located at the left-hand side of the control plate.

(4) Remove the heater control housing assembly from the inside of the instrument panel.

(4) To install heater control assemblies, reverse removal instructions.

c. Remove the heater blower assembly, if necessary:

(1) Disconnect blower motor wires.

(2) Remove blower to heater housing screws.

(3) Remove the blower assembly. Inspect the blower blades (1-24) for damage and bench check the motor (1-27). Replace defective parts as necessary.

d. Remove the heater core, if necessary:

(1) Disconnect resistor wires. Remove six screws and remove the heater core cover (1-20).

(2) Loosen the heater hose clamps and disconnect the two heater hoses from the core (1-19).

(3) If necessary, replace heater hoses.

(a) Loosen the heater hose clamps and disconnect the hoses at the heater control valve and the water pump.

(b) Remove the heater hose clips and remove the hoses.

(c) To install heater hoses, reverse removal instructions.

(4) Slide the heater core (1-19) from the housing. Test it for leaks under water, using compressed air. Repair or replace the core assembly.

e. Pull the defroster hose (1-29) from its grommet (1-14) at the heater housing. Loosen the clamp and pull the defroster hose from the duct assembly (1-28). Check for obstructions or damage. Clear obstructions or replace defroster hose as necessary.

f. Check the heater control valve for leaks and proper operation and replace if necessary.

### 3-3. Under Seat Heater.

a. Remove the front seat cushion to expose the heater.

b. Working under the car:

(1) Remove two heater assembly to floor board nuts. Remove baffle plate.

(2) Disconnect heater hoses.

c. Disconnect heater motor wire.

d. Lift and remove heater assembly from vehicle.

### 3-4. Under Seat Heater Disassembly.

a. Perform operations in Section 3-3.

b. Remove two nuts and bolts holding upper and lower heater housings and fan blade screen.

c. Remove heater core. Repair or replace.

### 3-5. Servicing Heater Motor.

a. Perform operations in Sections 3-3 and 3-4.

b. Using screw driver, remove fan blade set screw.

c. Remove fan blade.

d. Remove two nuts holding heater motor to lower heater housing. Remove heater motor.

e. Test the heater switch and wiring using a test lamp.

f. Repair or replace parts as necessary.

g. Reverse disassembly instructions to reassemble.

## SECTION IV. FRONT SEAT

### 4-1. Seat Assembly.

a. With all A-12 models, remove the rear ash tray:

(1) Remove the ash tray liner.

(2) Remove two screws and remove the ash tray housing.

b. Pry off the upper and lower front seat moulding strips.

c. Remove ten mounting screws and remove moulding retainers.

d. Remove two trim panel mounting screws and washers. Remove the front seat trim panel.

e. Remove the front seat cushion assembly.

f. Remove two lower mounting bolts and hog rings at seat cover and lift the front seat back rest assembly up and out of the vehicle.

g. Repair or replace the cushion, cover assembly, and trim panel as necessary.

### 4-2. Manual Seat Adjuster.

a. Remove four nuts and lockwashers holding the support assembly to the adjuster assembly and remove the support frame.

b. Remove the cotter pin from the adjusting lever and disconnect the adjuster connection wire.

c. Unseat the adjuster latch springs.

d. Remove four screws and lockwashers holding each adjuster assembly to the floor pan of the vehicle. Lift the adjusters from the vehicle.

e. Repair or replace parts as necessary. To install, reverse removal instructions.

## SECTION V. REAR SEAT

### 5-1. Seat Backs.

a. Remove the rear seat cushion and remove two seat back lower mounting screws and lockwashers.

b. Pull the seat back assembly up to free the seat back hooks from the slots in the shelf panel.

c. Repair or replace the cushion, seat back, and cover as necessary.



## 5-2. Station Wagon Manual Folding Mechanism.

- a. Remove seat cushion.
- b. Remove ten X-washers and remove upper and lower right- and left-hand link assemblies. Remove nylon bushings and spring wave washers.
- c. Remove three nuts from each rear seat cushion frame front bracket assembly and remove the cushion frame.
- d. Remove two screws and lockwashers holding each side panel in the vehicle. Pull the side panels

from the torque tube and remove the torque tube and bushings.

e. Remove two mounting screws at lower rear seat cushion and remove the cushion.

f. Remove two screws at each follower panel hinge rear bracket. Remove the rear seat back and follower panel and hinge assembly.

g. Repair or replace parts as necessary. To install, reverse the order of removal.

## SECTION VI. AUXILIARY SEATS AND FLOOR MATS

### 6-1. Auxiliary Seats.

a. If auxiliary seat back pads or cushions are worn or damaged, pry them off and replace, or cement on new covers.

b. If necessary, remove the back assembly.

(1) Remove the auxiliary seat back hinge pin spring washer and retainer ring.

(2) Slide the hinge pin out and remove the back assembly.

c. Remove the cushion panel if necessary.

(1) Pry off the cushion and remove two screws and lockwashers underneath.

(2) Remove four screws under the seat panel. Remove the support assembly and slide the seat from the leg.

d. Remove the floor support and hinge assembly if necessary.

(1) Remove the rear floor mat assembly (see Section 6-2).

(2) Remove four auxiliary seat floor mounting screws and lockwashers and remove the floor hinge and support.

(3) Remove the auxiliary seat leg hinge pin spring washer and remove the hinge pin.

e. Replace damaged parts. Reverse removal instructions to install.

### 6-2. Floor Mats.

#### a. Front mats.

(1) Remove nine retainer mounting screws from each front floor mat retainer. Remove the two retainers.

(2) Remove two screws from the accelerator foot pedal anchor and remove foot pedal assembly.

(3) Lift out the floor mat.

(4) To install, reverse removal instructions.

#### b. Rear floor mats.

(1) Remove the front floor mat retainers, as in Section 6-2a.

(2) Remove nine retainer mounting screws from each rear floor mat retainer. Remove the two retainers.

(3) If the vehicle has a foot rest, remove four mounting screws and remove the foot rest assembly.

(4) If the vehicle is equipped with auxiliary seats, remove the auxiliary seat backs and cushion panels. See Section 6-1.

(5) Raise the floor mat over the auxiliary seat legs and remove from the vehicle.

(6) To install the rear floor mat, reverse the order of removal.